

Inner Melbourne Action Plan
Progress Report
Action 9.4 Green Demonstration Projects

Purpose

1. To update the Committee on the progress of the Growing Green Guide for Melbourne: a how-to guide for green roofs, walls and facades project.

Background

2. This project is a partnership between the Cities of Melbourne, Port Phillip, Stonnington and Yarra through IMAP and the University of Melbourne.
3. Using a collaborative approach between government, commercial and research sectors, the Guide includes best practice guidelines and policy recommendations that can be readily utilised by councils, building developers and planners across Victoria.
4. The Department of Sustainability and Environment Local Sustainability Accord awarded \$250,000 to this project in August 2011 and IMAP councils committed \$130,000 contribution at an IMAP executive forum on 18 October 2011.
5. This project is aligned with IMAP Action 9.4: Green Demonstration Projects.

Progress to date

6. The project plan, communications plan and engagement plan have been finalised, meeting Milestone 1 of the Local Sustainability Accord's funding agreement. These plans have been highly complimented by the Department of Sustainability and Environment and will be used as a best practice example for other project teams.
7. A research officer has been employed through the University of Melbourne, and is working with the project officer to implement the project.
8. The 2011/12 project income was \$150,000, from the Department of Sustainability and Environment. Expenses in 2011/12 were \$72,000 which included the project officer's salary and overheads of \$28,000 and a \$40,000 payment to the University of Melbourne, for them to employ the research officer.
9. The project was officially launched in May 2012, at an event on the City of Melbourne's Council House 2 rooftop garden. Over 100 people attended the launch

and heard from representatives of the project partners. IMAP was promoted and represented by Mayor Chandler, City of Stonnington. The team from a complementary IMAP project, "ESD factsheets" also joined the event to launch their product. The launch received positive feedback from all involved.

10. The project's communications campaign has begun with a project webpage established on the IMAP website and weblinks to this site on partner organisations' websites. The webpage has been viewed more than 250 times since it's development in July. A project newsletter has also been produced and currently has over 70 subscribers. A media release was issued coinciding with the launch of the project, and resulted in a number of online and print publications (see example from the InDesign website attached).
11. Implementation of the engagement plan has begun. A stakeholder list has been developed, identifying more than 250 council, industry, academic and state government contacts. The first key stakeholder workshop was held with 40 stakeholders providing input on the scope of the guidelines and the key issues to be covered in the policy options paper (see summary of workshop attached). In mid August the City of Melbourne's Canopy: green roof forum was also used to communicate and invite feedback on this project with more than 100 stakeholders. Invitations were open to all members of the community and promoted to over 800 interested people through the Canopy contact list, on council websites and through sustainability newsletters.

Recommendations

12. That the IMAP Implementation Committee note the progress of the Growing Green Guide for Melbourne project.

Growing Green Guide for Melbourne

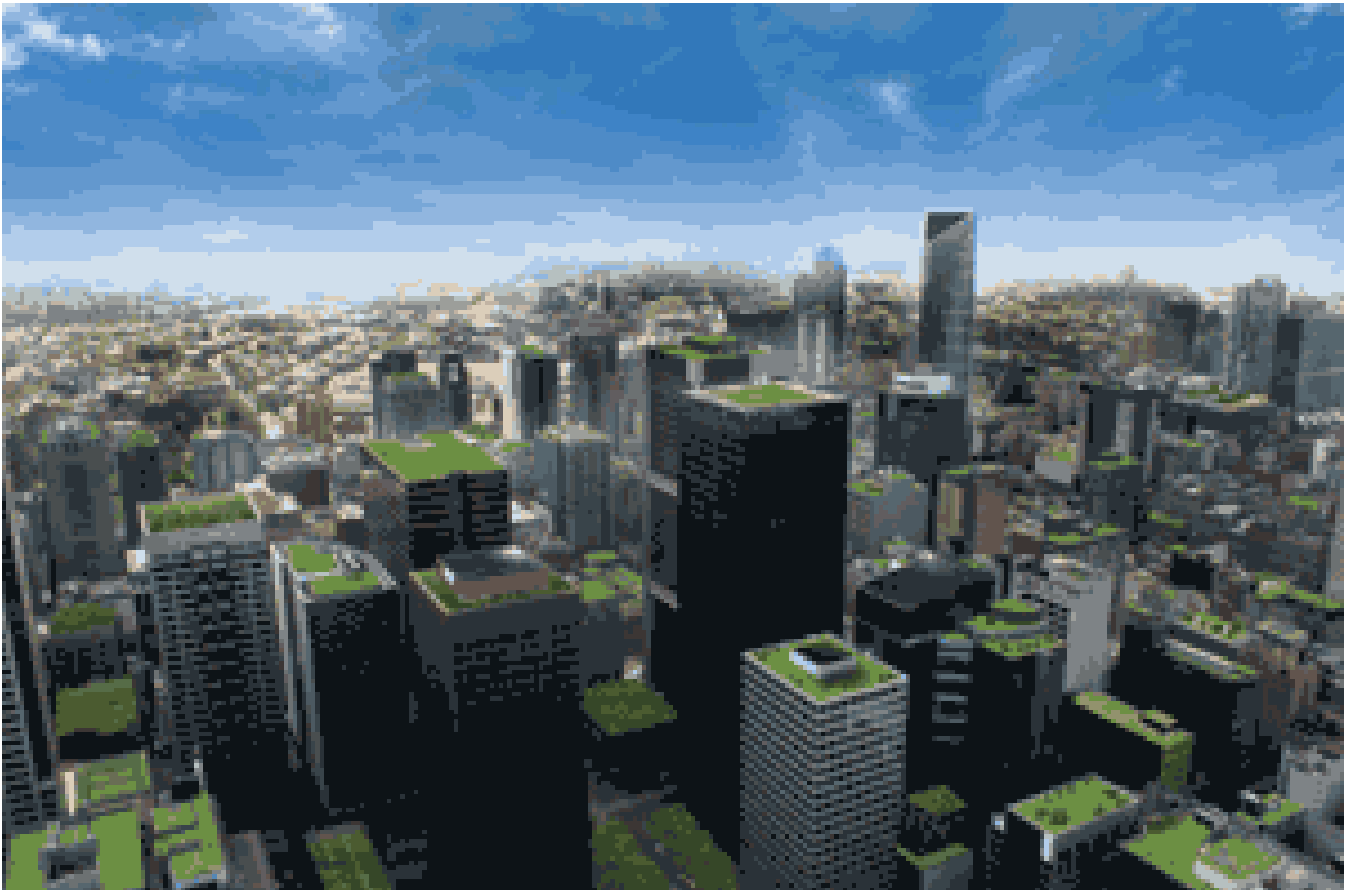

Workshop Summary



Inner Melbourne Action Plan
'Making Melbourne More Liveable'



Victorian Local Sustainability Accord

Sustainability Fund



The first Stakeholder Workshop for the Growing Green Guide for Melbourne project was held in Melbourne on August 2nd, 2012.

The participants included:

Warwick	Savvas	Aspect Studios
Merran	Porjasoski	BENT Architecture
Roger	Sykes	Bonacci Group
Anila	Weerakkody	Building Commission
Ralf	Pfleiderer	City of Melbourne
Jeff	Nelson	City of Melbourne
Brendan	Cousins	City of Melbourne
Tiffany	Crawford	City of Melbourne
Ros	Rymer	City of Melbourne
Caroline	Chandler	City of Port Phillip
Sarah	Ransome	City of Port Phillip
Leon	Yates	City of Port Phillip
Rhiannon	Saward	City of Port Phillip
Sam	Innes	City of Port Phillip
Andrea	Pagliaro	City of Stonnington
Chrisanthy	Semertzidis	City of Stonnington
Dan	Nunan	City of Yarra
Andrew	Griffin	City of Yarra
Karen	Hucker	City of Yarra
Euan	Williamson	City of Yarra
John	Curtis	City of Yarra
Mark	Gebbie	City of Yarra
Tania	Crisafi	Dept of Planning and Community Development
Brod	Street	Dept of Sustainability and Environment
Carlo	Missio	GHD
Ben	Nicholson	Groof Consulting
Matt	Mackay	Hassell
Ken	Hitchcock	KHD Landscape Engineering Solutions
Anthony	Kachenko	Nursery and Garden Industry of Australia
Ralph	Webster	Pad Creations
Alexei	Trundle	RMIT University
Rafael	Katigbak	Ronstan Tensile Architecture
Ole	Fryd	University of Melbourne

Rationale

The workshop was held so that participants could:

1. Get to know more about the project, meet the project team and other workshop participants.
2. Provide expert advice from their field on how the project would affect their workplaces and/or professions.
3. Help shape the key ideas and topics which need to be explored in the guidelines and policy documents.

The intention was that the project team would gather the ideas and input to help shape the project outputs and determine 'next steps' in developing the Growing Green Guide for Melbourne project.

Synopsis of the afternoon

The workshop began with introductions, and getting to know the different experiences and backgrounds of others in the room.

This was followed by a short presentation about the project, from Sue Murphy and Julie Francis, outlining what the project was trying to achieve, where it had originated from, who was involved and the project timeline.

The participants broke into smaller groups following afternoon tea. Approximately ten people formed a discussion group about the guidelines, chaired by Sue Murphy. Another ten formed a discussion group about technical specifications, chaired by John Rayner.

Twenty people moved into a policy workshop, chaired by Gail Hall, who provided an overview of policy interventions elsewhere in the world, and ran a short video on green roofs, from the ABC's catalyst program in Melbourne in 2010. A workshop followed where participants gave ideas on incentive and regulatory ("carrot and stick") approaches to encouraging development of more green roofs, walls and facades. Participants also considered where a policy about green roofs, walls and facades would sit relevant to work area, organisation, department etc and also which existing Strategies, plans, policies and frameworks are relevant to this subject to provide a context for the policy options paper.

A short report back from each of the three groups occurred before the close of the meeting.

Throughout the workshop people were asked to consider three questions:

- Who else should be involved?
- What wasn't discussed today that needs to be considered?
- Where could the guidelines sit in the long term?

The project team is still interested in hearing feedback on the above questions and is open to any comments that participants want to add to this record of ideas from the workshop.

Results of the Policy Workshop

A summary of the policy workshop is provided below. The project team has another 5 pages of raw data captured from the day.

It was recognised that policy and regulatory tools to support green roof, wall and façade policy could be based in a range of different organisations. These include different state and local government agencies to organisations such as the Building Commission, Business Council of Australia and Australian Building Codes Board.

Participants identified that green roofs, walls and facades are relevant to a range of work areas, including:

- Environment and water
- Energy Efficiency
- Waste reduction and recovery
- Tourism and culture
- Health
- Economic development
- Community gardens
- Urban agriculture and food policy

A number of existing programs, plans and strategies are considered relevant to the Growing Green Guide for Melbourne project, especially those local councils, for instance:

- Climate Change Adaptation Strategies
- Water Plans
- Municipal Strategic Statements
- Structure plans
- As well as a range of Council-specific plans and programs, such as the City of Port Phillip's Health Plan or Alternative Greening Strategy, or the City of Melbourne's Urban Forest Strategy or 1200 Buildings Program.

Opportunities were identified to link in with planning systems across state and local government, such as the planning scheme, Sustainable Design Standards, Design Review Panel and the new Metropolitan Planning Strategy.

Policy and regulatory options which could be considered to support and encourage the development of more green roofs, walls and facades in the inner Melbourne region:

New policies or codes

- Introduce Local Planning Policy
- Introduce State Planning Policy
- Introduce Voluntary code

Inclusion in existing codes, standards and guidelines

- GreenStar
- Rescode standards
- Activity Centre Zones
- Building Code Australia
- Plumbing Code
- First Rate
- High Density Residential Design Guidelines

New regulations

- Insist on greening as part of a condition on planning permits, or as mandatory in order to meet certain Council targets

Incentives

- Free advice / technical expertise/ drafting assistance to people wishing to incorporate green roofs, walls or facades into a development
- Rate rebates or waiving of fees
- Fast track planning applications which include green roofs or walls

- Provide exemptions on some planning regulations for buildings that include green roofs, walls or facades.
- Provide funding or low interest loans to support development of green roofs, walls or facades
- Promotion of developers who build green roofs, walls and facades (awareness raising through sustainable building events, reputation building).

Results of the Guidelines Workshop

A summary of the guidelines workshop is provided below. The project team has another 15 pages of raw data captured as notes from the discussion.

The guidelines workshop discussed the difference between the guidelines and the 'technical specifications'. It was suggested that the guidelines could be more descriptive and the specifications more detailed, including metrics. It was also suggested that the guidelines focus on why have a green roof, wall or facades, benefits, risks, costs and the technical specifications help people understand how to implement and construct green roof, wall and façade projects. Another suggestion was that the guidelines are a series of questions, to help people think critically about their project and the specifications could be a series of answers.

There was discussion about how strict the specifications would be. People wanted to see them as a guides, resource or reference to help users, but not set absolutes. This would ensure that creativity was not stifled new designs could still be developed. Because the experience and research in Australian conditions is still rather limited, it was felt that the technical standards should not be too strict, but more a guide.

The guidelines workshop also discussed the intended audience and suggested that it should be targeted at people implementing commercial projects. It would still be relevant to DIY types, but would be targeted at people with some understanding of green roofs, walls and facades.

It was suggested that guidelines could be presented in different phases – design phase, specification phase, execution phase and maintenance phase. In the design phase it would be important to prompt people to think about the objective of their design. Maintenance is important to emphasise, so that these projects have longevity. The guidelines would provide an overview of materials involved in green, roof, wall and façade construction. Also cost ranges, structural requirements, safety considerations and access issues.

The importance of useful examples and case studies was highlighted. People want to see good analysis of case studies – explanation of what was successful or a failure and why

Specific issues that were discussed in more detail included:

- Building structure as important starting point for roof, wall or façade design
- Difficulty of supply of products in Australia – growing media and plants
- Relevance of German green roof guidelines – opportunity to build from this and develop for Australian conditions
- Importance of definitions, these flow into standards and specifications. Also definitions could exclude roof top gardens or internal green walls.
- Research is important to inform the guidelines and specifications
- Format could include factsheets, hard copy manual, PDF download and/or a website
- A website should have links to other relevant sites and be able to be updated
- Assessment of performance of green roofs, walls and facades is important – could have annual assessments and a checklist for maintenance.
- It is important to be able to learn from failures and give advice that helps people avoid mistakes that have been made before. Risks should be outlined.
- Matrix, table and checklist formats could be used to convey information
- Themes for consideration could be weight, water, wind and plants
- Communication is important to ensure the existence of the guidelines will be known.
- Specifications should be detailed enough to enable people to attain relevant environmental rating points.
- The guidelines would help people work through a process, give them ideas for design. There was a sense that the guidelines should be an education tool.

Where to next?

All participants are invited to feed back comments on this workshop summary, to julie.francis@melbournre.vic.gov.au. Anyone who wants to see the raw data captured from the event can also request this from Julie.

A second stakeholder workshop will be held on August 15th, as part of the Canopy green roof forum.

The project team will use the results of both stakeholder workshops to create a scoping paper, outlining what topics the guidelines document will encapsulate. This document will be available on the project's [website](#) in late September.

A policy reference group and guidelines reference group will be formed to provide advice to the project officer and research officer about the next steps for the policy options paper and development of the guidelines.

Further workshops and meetings will be scheduled to inform the writing of specific parts of the guidelines and policy options paper. The intention is to have draft documents prepared for public comment by mid 2013.

News updates of how the project is progressing are available by signing up to the Growing Green Guide Newsletter [here](#).

The GGGM project is a joint initiative of the Cities of Melbourne, Port Phillip, Stonnington and Yarra, along with the University of Melbourne. The project is supported by Victorian Government's Sustainability Fund under the Victorian Local Sustainability Accord.

<http://www.indesignlive.com/articles/in-review/report/Growing-Green-Guide-for-Melbourne#axzz22orzeyRR>

IN REVIEW



18 May 2012

Growing Green Guide for Melbourne

A new initiative by the City of Melbourne aims to develop a greener, more lush Melbourne. Annie Reid reports.

Picture this – Melbourne's city rooftops covered in lush greenery.

It may sound fanciful, but a new project launched last week by the [City of Melbourne](#) is hoping to green our buildings and houses for good.



*Plants on balconies and rooftops are increasingly popular.
Photo: Shannon Reddaway*

The Growing Green Guide for Melbourne was fittingly presented on the rooftop garden of the council's CH2 building, and will be produced by the Inner Melbourne Action Plan (IMAP) comprising the 4 inner city councils - Melbourne, Yarra, Stonnington and Port Phillip – as well as the University of Melbourne.

The project will comprise a 'how to' handbook guide on constructing a green roof or wall, and help people consider all the aspects they need to cover before transforming these spaces into vegetated, leafy habitats.

It will also identify prime sites for the future development of green roofs, walls and façades in inner Melbourne, says The University of Melbourne's senior lecturer, John Rayner.

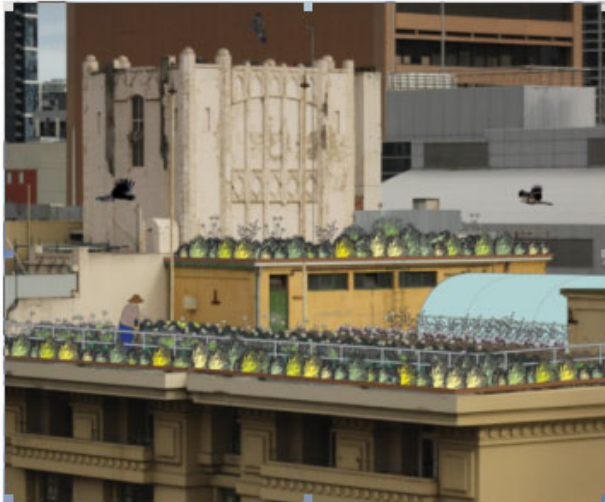

Artist Stephen Mushin depicts his view of a flower farm atop a Swanston Street building.

"While the criteria for this has yet to be determined, it will most likely identify sites determined in terms of environmental outcomes, such as a reduction in storm water flows, sites with a high public focus or with minimal planning and heritage issues."

Cr John Chandler, the mayor of Stonnington and an architect, also launched a series of fact sheets on behalf of IMAP, to help building designers meet sustainability requirements during the planning stage of all development and extension designs.

"I am very much looking forward to this. It's good for residential, good for design and good for the environment," he said.



A childcare centre green roof in the Docklands.

The Growing Green Guide handbook will be published in December next year, while the fact sheets can be downloaded from each council's web site now.

The project is funded through the Victorian Government's Sustainability Fund under the Victorian Local Sustainability Award.



A green façade in the Melbourne CBD.

GROWING GREEN GUIDE FOR MELBOURNE – 2012 EVENTS



Growing Green Guide project launch



Growing Green Guide first stakeholder workshop



Growing Green Guide second stakeholder workshop

